

SPECIFICATION for AC Series Modules

■ Model No. AC4-W

Product Image



Features

AC Power operated LED Module solution (100~240V)

No extra converter, No extra expenses

“Safety Fuse built-in” to prevent Fire incidents

Constant Current drive

– “Fully warranted Stability” with High energy efficiency (58lm/W)

Max. connection up to 250 modules

Reverse voltage, current protection

120° Viewing angle creates better silhouettes with even light distribution

Durable epoxy resin fill for waterproof rating with IP68

Product dimension and connections

Case Dimension : 44L × 44W × 11H mm,

Weight : 22g per module

LED Pitch : 28mm, Wire length : 100mm,

Center to Center : 144mm

Maximum run in series : 250 modules

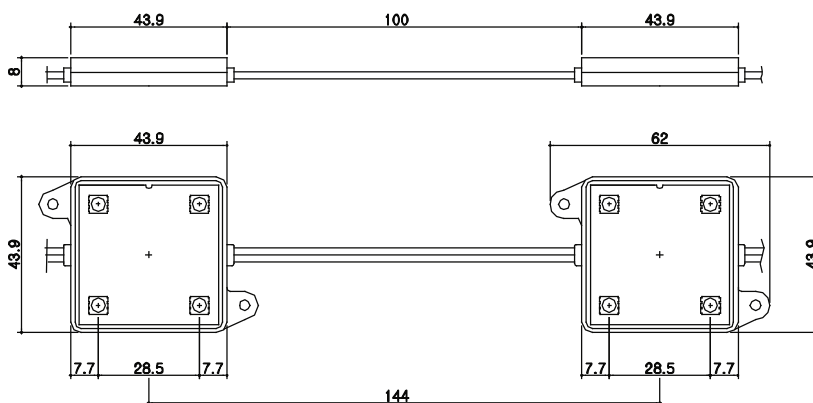

Product dimension and connections

Product No.	[AC4 - W]			
Color	W	R	G	B
Operating Power	AC 100 ~ 240 V			
Power / Current Dissipation	0.92 W, 9.2A			
LED Spec	120° Viewing angle, 50,000hr rated life, made in Korea			
Luminous intensity(mcd)	22,000	8,400	14,400	3,200
Luminous intensity(lm)	62.4	23.7	40.7	9.1
Dominant Wavelength	-	625	400	525
Standard Color Temperature	8,500	-	-	-
Module connection & Cuttability	Wire to Wire Series connection, every module			
Recommended Channel Height	Min. 80mm			
Operating Temperature	-20°C~ 60°C			
Storage Temperature	-30°C~ 70°C			
Waterproofing rate	IP68			
Cable	awg18, 1007-SPT-1(105°C)			
Case Materials	ABS housing + Ductile Epoxy Treatment			

SPECIFICATION for AC Series Modules

■ Model No. AC2-W

Product Image



Features

- AC Power operated LED Module solution (100~240V)
- No extra converter, No extra expenses
- “Safety Fuse built-in” to prevent Fire incidents
- Constant Current drive
- “ Fully warranted Stability” with High energy efficiency (58lm/W)
- Max. connection up to 300 modules
- Reverse voltage, current protection
- 120° Viewing angle creates better silhouettes with even light distribution
- Durable epoxy resin fill for waterproof rating with IP68

Product dimension and connections

Case Dimension : 66L × 19W × 11H mm, Weight : 16g per module

LED Pitch : 40mm, Wire length : 100mm, Center to Center : 166mm

Maximum run in series : 300 modules

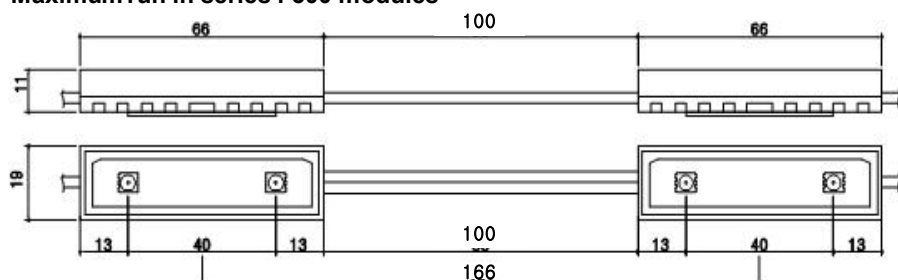

Product dimension and connections

Product No.	[AC2 - W]			
Color	W	R	G	B
Operating Power	AC 100 ~ 240 V			
Power / Current Dissipation	0.6 W, 6A			
LED Spec	120° Viewing angle, 50,000hr rated life, made in Korea			
Luminous intensity(mcd)	11,000	4,200	7,200	1,600
Luminous intensity(lm)	31.2	11.9	20.3	4.5
Dominant Wavelength	-	625	400	525
Standard Color Temperature	8,500	-	-	-
Module connection & Cuttability	Wire to Wire Series connection, every module			
Recommended Channel Height	Min. 80mm			
Operating Temperature	-20°C~ 60°C			
Storage Temperature	-30°C~ 70°C			
Waterproofing rate	IP68			
Cable	awg18, 1007-SPT-1(105°C)			
Case Materials	ABS housing + Ductile Epoxy Treatment			