

SPECIFICATION for MINI Modules

Model No. MINI 3-W

Product Image

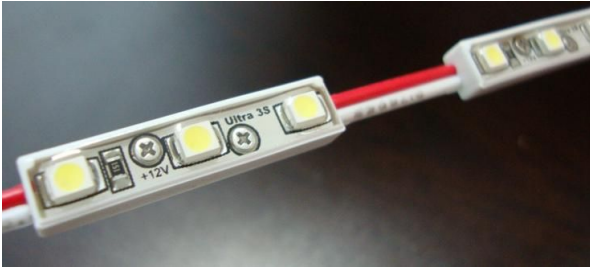

Product dimension and connections

Case Dimension : 29L × 6W × 5H mm

Weight : 3g per module

LED Pitch : 11mm

Center to center of modules : 49mm

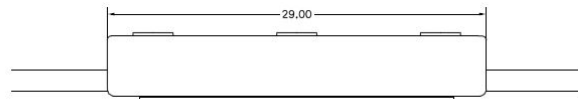
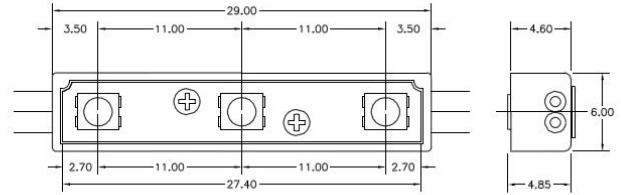

Features

Compact design with Ultra small size

Specialized for very low and narrow channel letter

High efficiency, High luminosity (60 lm/w)

Constant luminosity through minimizing voltage drop (-0.14V at the last 50pcs)

20mA*3EA, 3528 SMD LED mounted (Patent Free)

120° Viewing angle creates better silhouettes with even light distribution

Durable epoxy resin fill for waterproof rating with IP68

12V DC operation requires a constant voltage Power supply (Provided separately)

Specification

Product No.	[MINI 3 - W]				
Color	W	R	G	B	AB
Operating Power	DC 12V				
Power / Current Dissipation	0.24W, 20mA				
LED Spec	120° Viewing angle, 50,000hr rated life, made in Korea				
Luminous intensity(lumen)	15	NA	NA	NA	NA
Dominant Wavelength	-	-	-	-	-
Standard Color Temperature	12,000	-	-	-	-
Module connection & Cuttability	Wire to Wire Series connection, every module				
Recommended Channel Height	Min. 30-35mm				
Operating Temperature	-20°C~ 50°C				
Storage Temperature	-30°C~ 70°C				
Waterproofing rate	IP68				
Cable	AWG22 * 2C				
Case Materials	ABS housing + Ductile Epoxy Treatment				

* Since NC LED has launched white color module at first. Colored modules will be available depends on your order.